

# Baker 1st Floor East

Atrium

Lobby Area

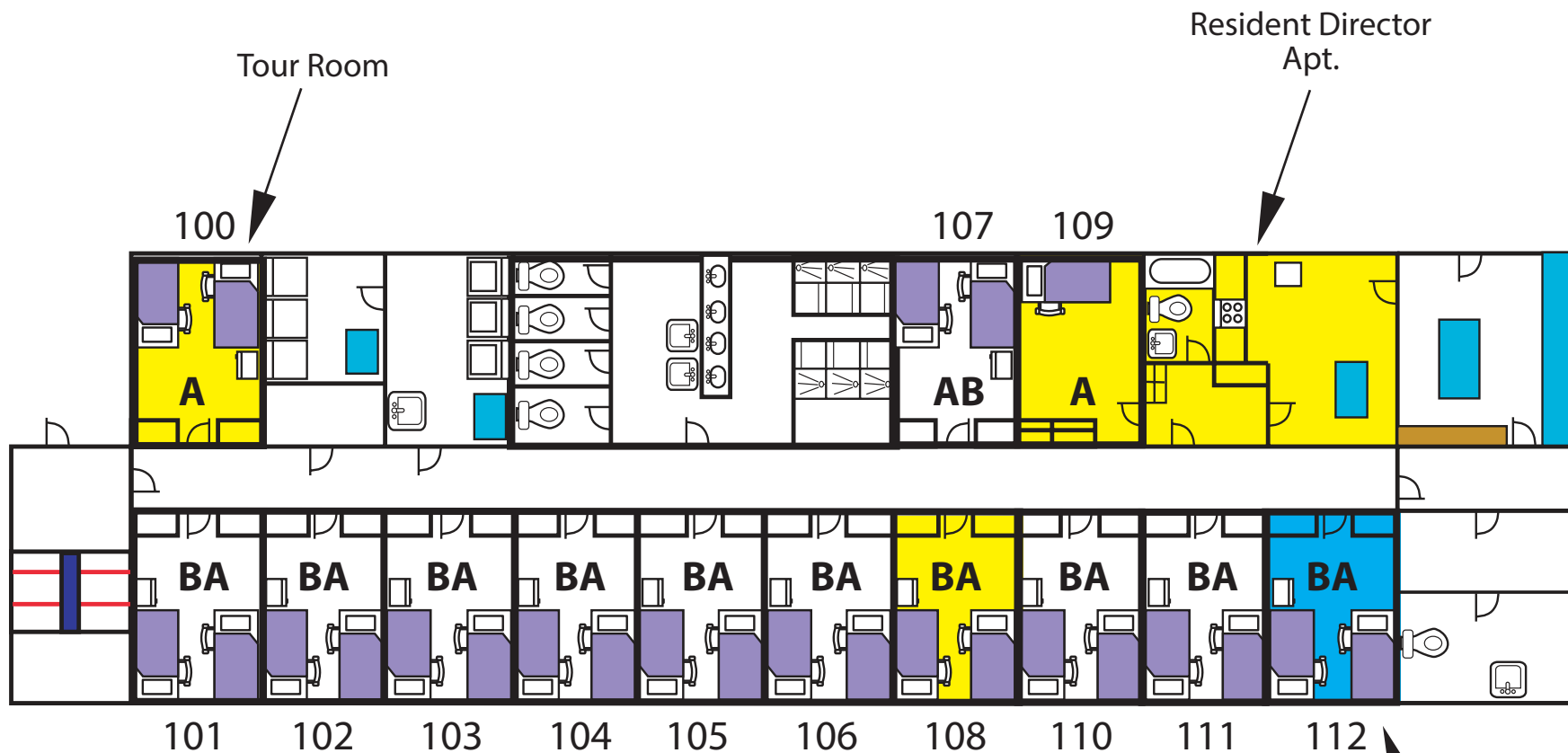

Female

Accessible Information:  
All first floor units - wheelchair  
Hearing & Visual (Fire Alarm)  
Baker 112

# Baker 1st Floor West

Lobby Area

Lot P27

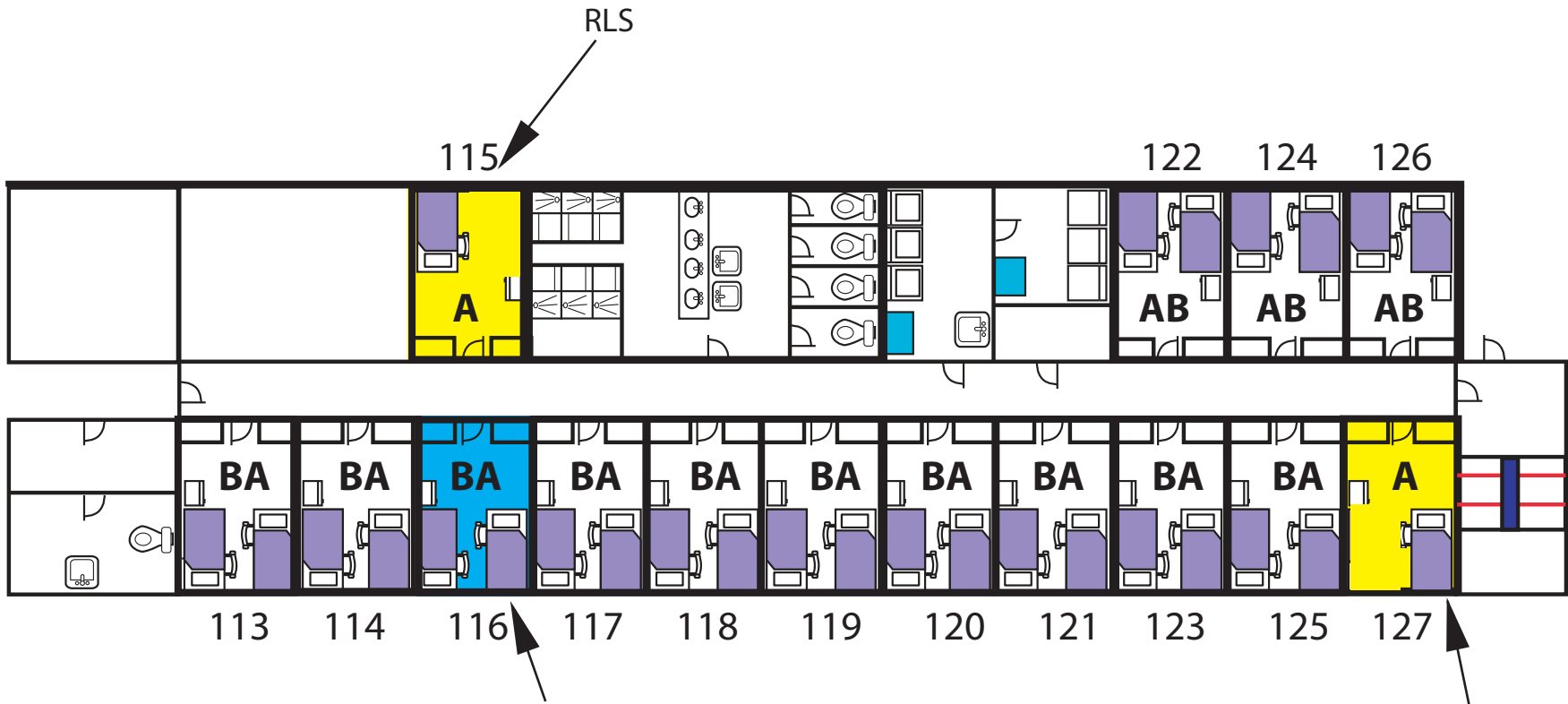

Accessible Information:  
All first floor units - wheelchair

---

Hearing & Visual (Fire Alarm)  
Baker 116

Male

# Baker 2nd Floor East

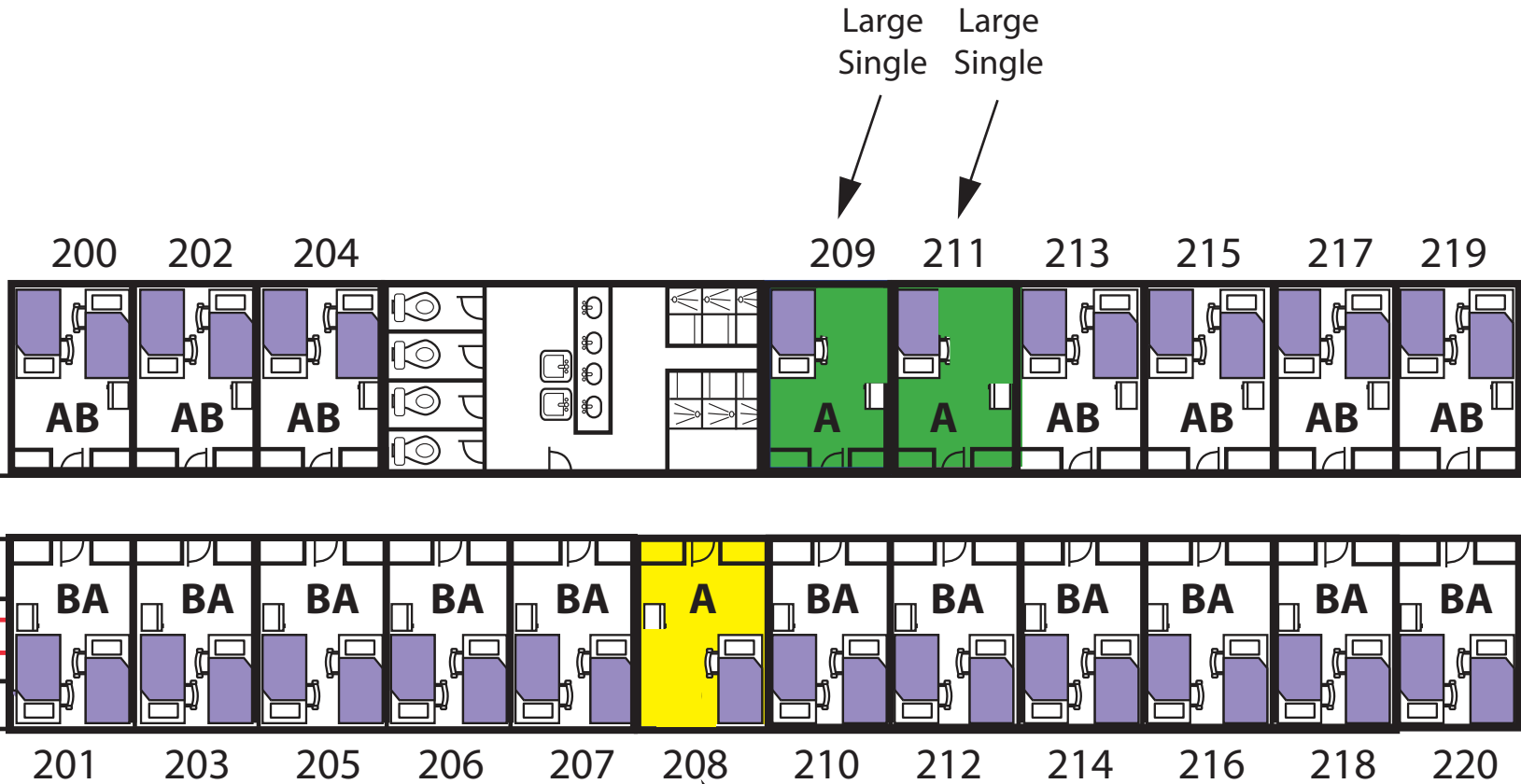

Atrium

Junction Area

RLS

Male

# Baker 2nd Floor West

Junction Area

Lot P27

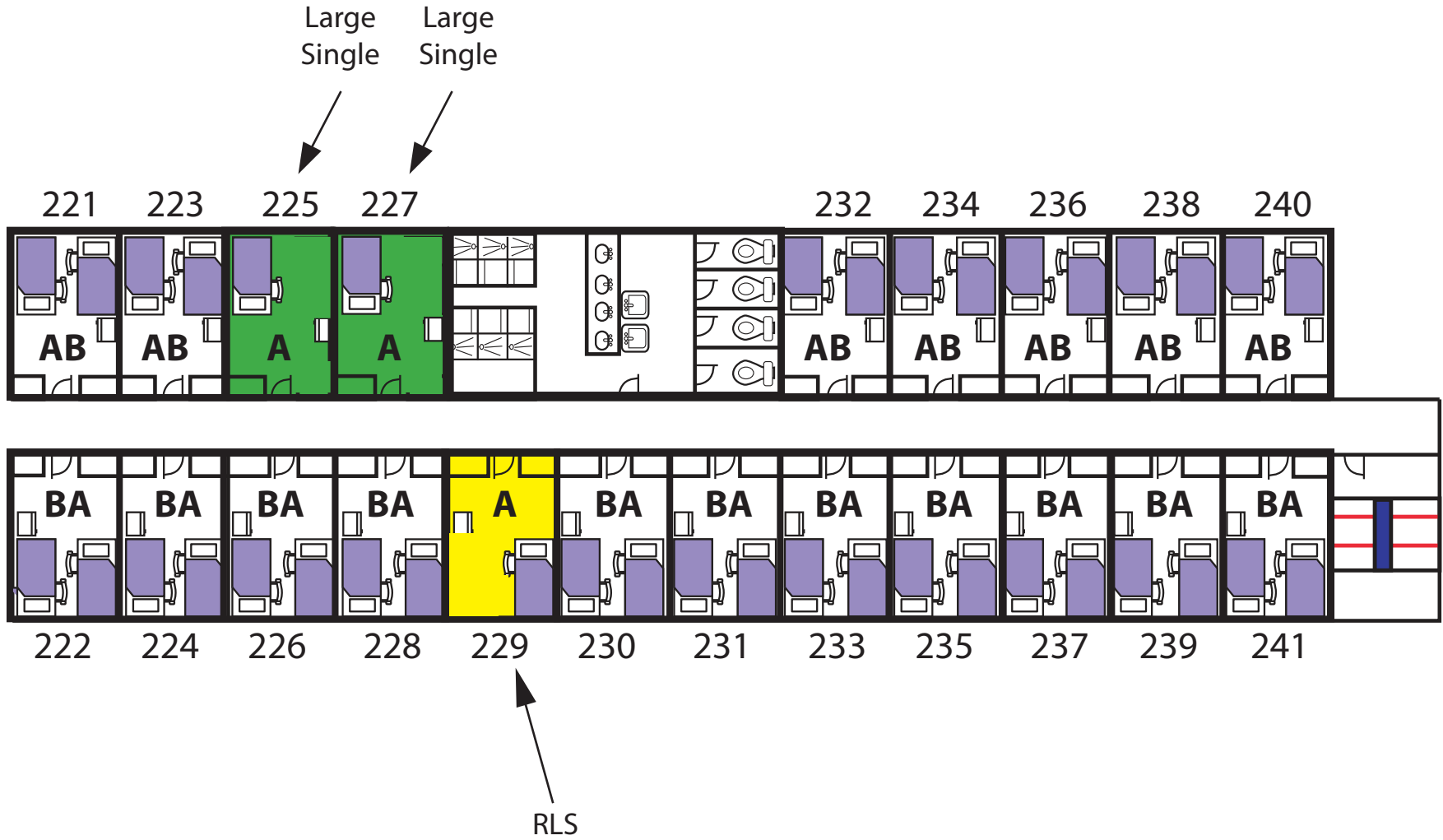

# Baker 3rd Floor East

Atrium

Junction Area

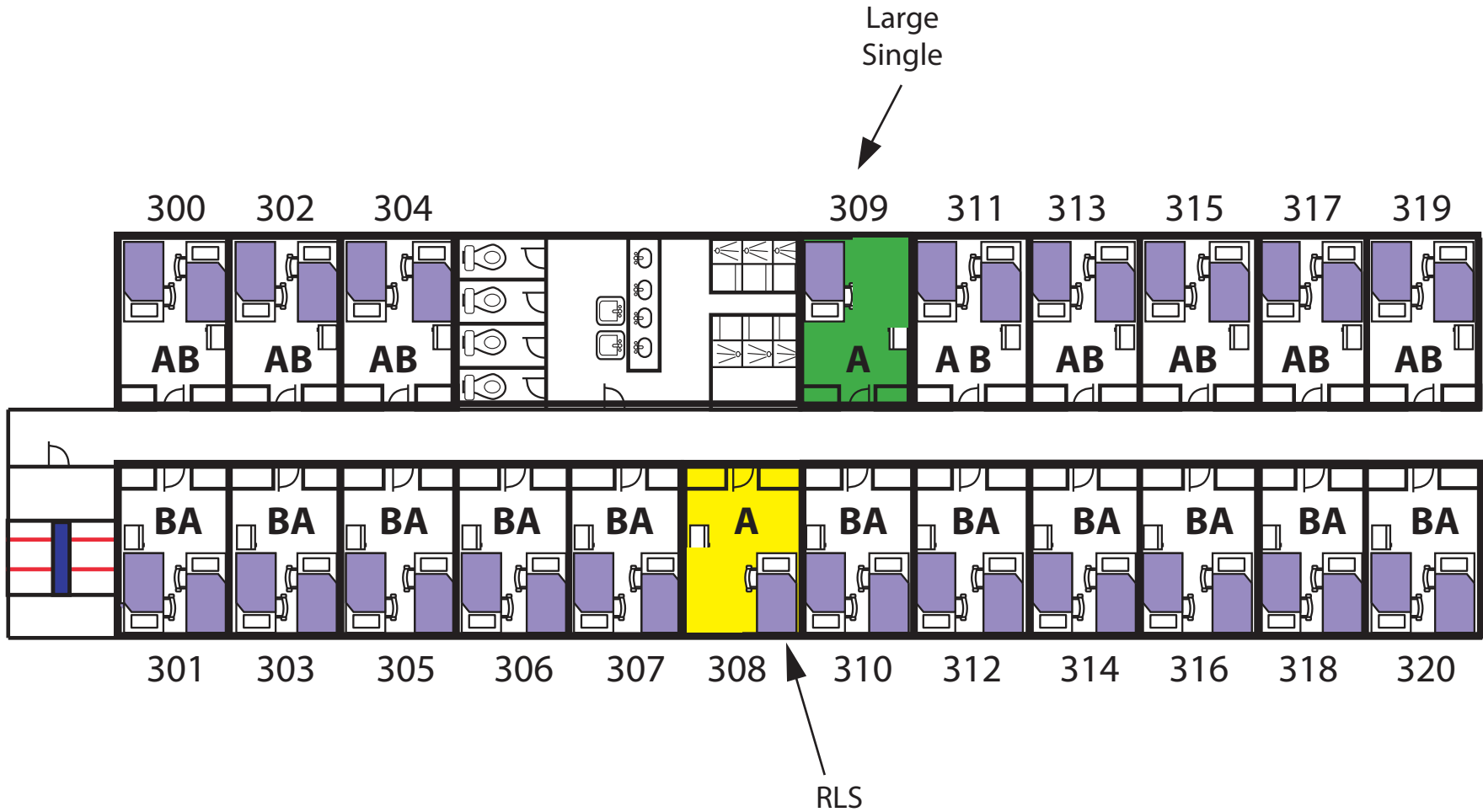

Female

# Baker 3rd Floor West

Large Single    Large Single



321    323    325    327    332    334    336    338    340

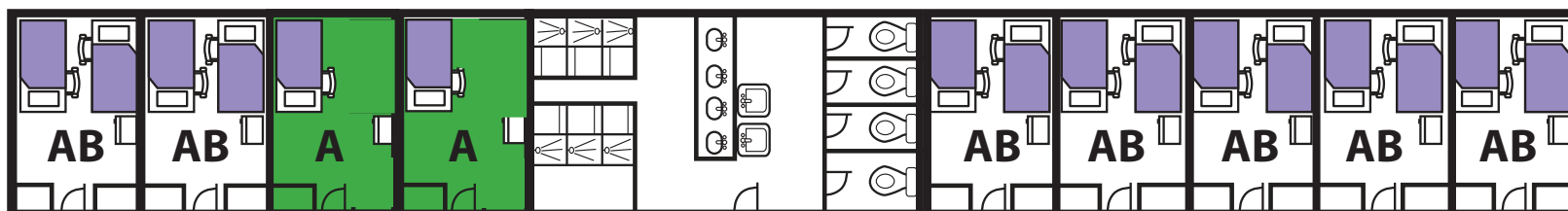

322    324    326    328    329    330    331    333    335    337    339    341



RLS

Female

Junction Area

Lot P27